

RYOBI®

CLL-360

GB OWNER'S OPERATING MANUAL

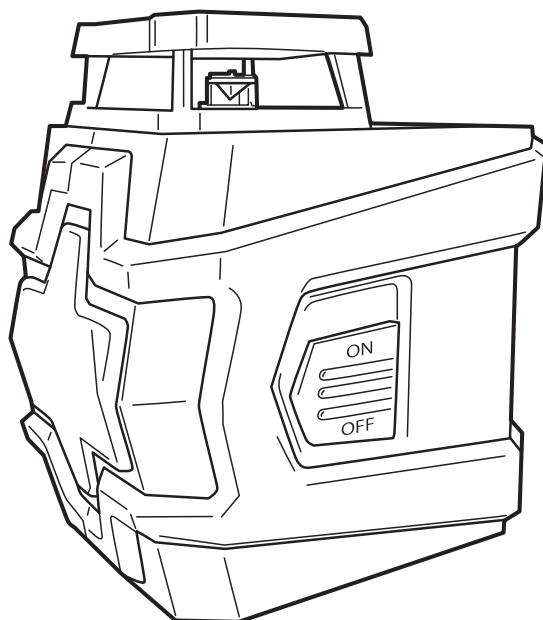

CE

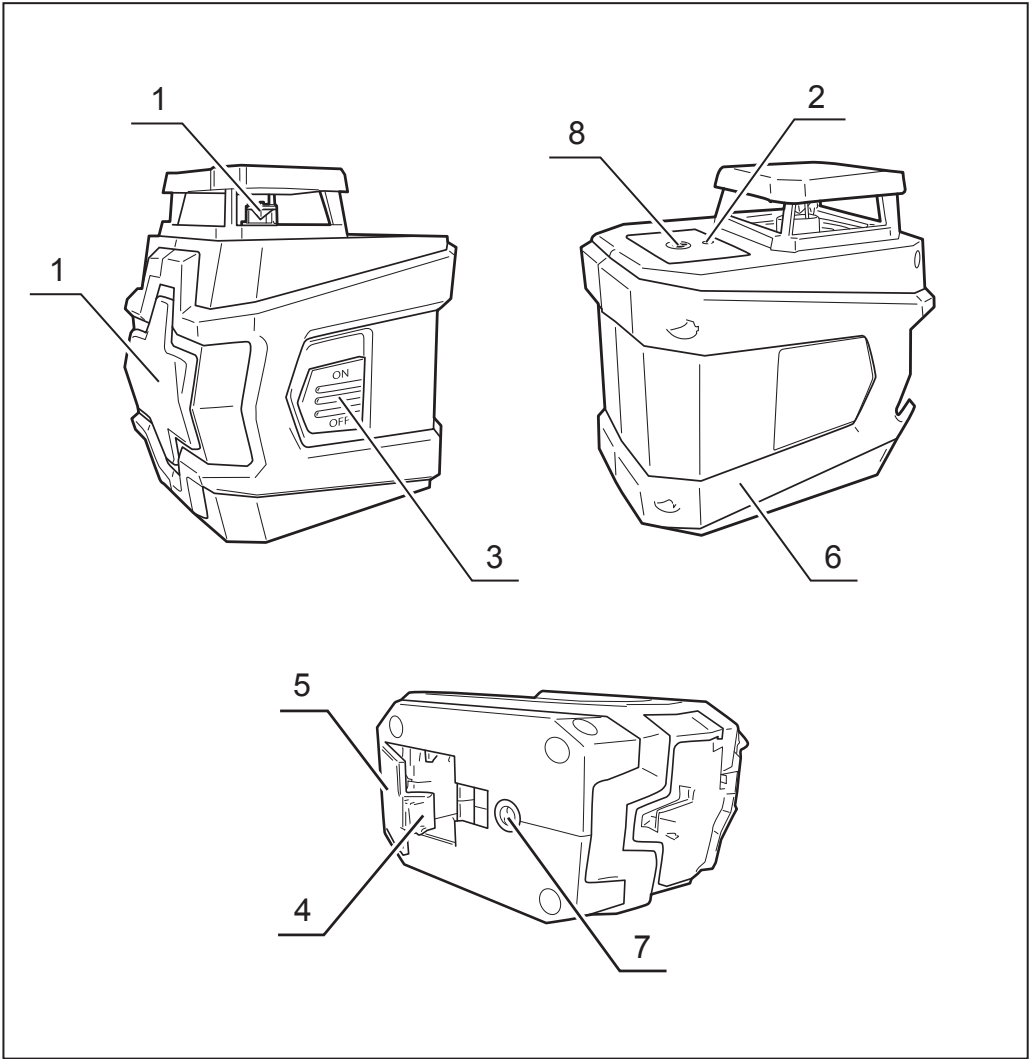

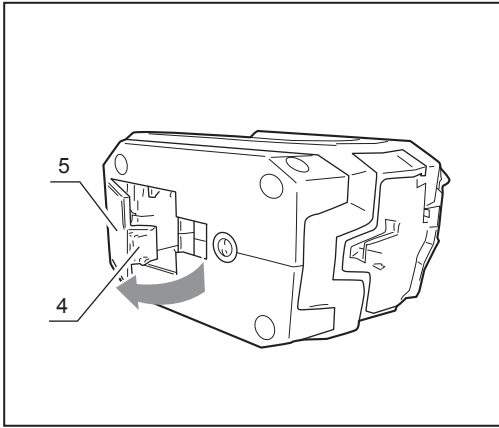

Fig. 1

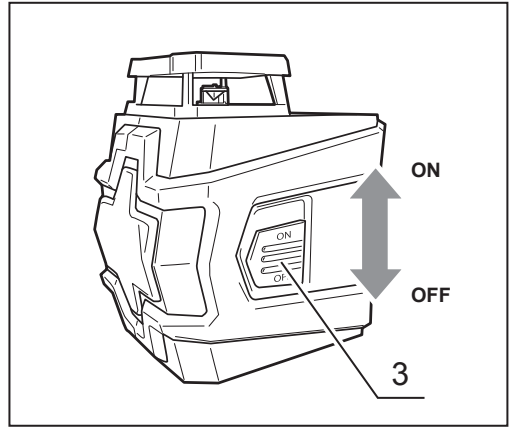

Fig. 2

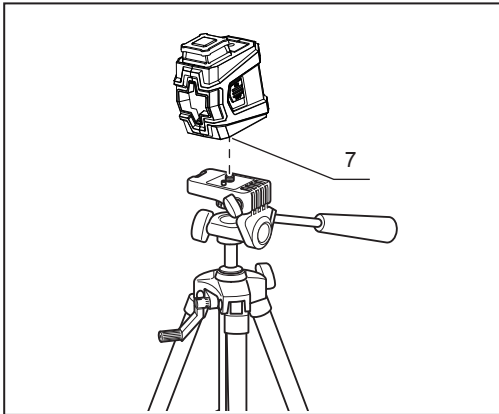

Fig. 3

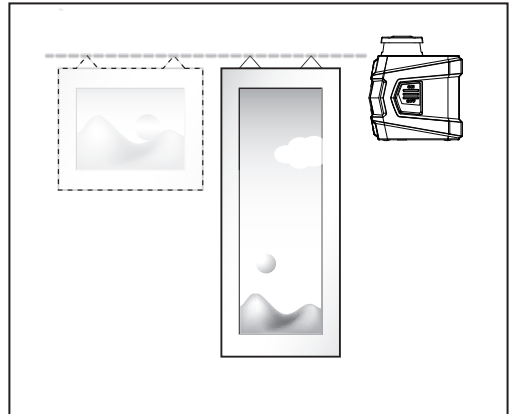

Fig. 4

THANK YOU FOR BUYING A RYOBI PRODUCT.

To ensure your safety and satisfaction, carefully read through this OWNER'S MANUAL before using the product.

General Safety Rules

All instructions must be read and observed in order to work safely with the measuring tool. Never make warning signs on the measuring tool unrecognizable.

SAVE THESE INSTRUCTIONS FOR FUTURE REFERENCE AND INCLUDE THEM WITH THE MEASURING TOOL WHEN GIVING IT TO A THIRD PARTY.

Caution! The use of other operating or adjusting equipment or the application of other processing methods than those mentioned here can lead to dangerous radiation exposure.

- The measuring tool is provided with a warning label.



- If the text of the warning label is not in your national language, stick the provided warning label in your national language over it before operating for the first time.



Do not direct the laser beam at persons or animals and do not stare into the direct or reflected laser beam yourself, not even from a distance. You could blind somebody, cause accidents or damage your eyes.

- If laser radiation strikes your eye, you must deliberately close your eyes and immediately turn your head away from the beam.
- **Do not use the laser viewing glasses as safety goggles or in traffic.** The laser viewing glasses are used for improved visualisation of the laser beam, but they do not protect against laser radiation.
- **Do not make any modifications to the laser equipment.**
- **Have the measuring tool repaired only through qualified specialists using original spare parts.** This ensures that the safety of the measuring tool is maintained.
- **Do not allow children to use the laser measuring tool without supervision.** They could unintentionally blind other persons or themselves.
- **Do not operate the measuring tool in explosive environments, such as in the presence of flammable liquids, gases or dusts.** Sparks can be created in the measuring tool which may ignite the dust or fumes.

APPLICATIONS

The measuring tool is intended for determining and checking horizontal and vertical lines.

The measuring tool is suitable exclusively for operation in enclosed working sites.

DESCRIPTION

1. Laser aperture
2. Automatic leveling indicator
3. On/Off switch
4. Latch of battery lid
5. Battery lid
6. Contact surface
7. Tripod mount (1/4")
8. Laser line projection mode select button

SPECIFICATIONS

Working range (typically)	10m
Measuring accuracy (typically)	±0.5mm/m
Leveling time	<4s
Leveling range	>4°
Operating temperature	0 °C to 40 °C
Laser class	4
Laser type	635 nm, <1mW
Batteries	2 x 1.5V (AA)
Estimated battery life	approx. 15hrs. (use alk. AA)
Net weight	0.33kg

The safe use of this product requires an understanding of the information on the tool and in this instruction manual, as well as knowledge of the project you are attempting. Before use of this product, familiarize yourself with all operating features and safety rules.

INSERTING/REPLACING BATTERIES (Fig. 1)

Using alkaline batteries is recommended for operation of the measuring tool.

1. Press the latch of the battery lid (4) to open the battery lid (5).
 2. Insert 2pcs new battery according to the polarity indicators in the battery compartment. Be sure the polarity (+/-) is correct.
 3. Close the battery lid and lock it securely in place.
- Always turn off the tool before installing or replacing the batteries.
 - When inserting, pay attention to the correct polarity according to the representation on the inside of the battery compartment.
 - Always replace all batteries at the same time. Do not use different brands or types of batteries together.
 - **Remove the batteries/rechargeable batteries from the measuring tool when not using it for longer periods.** When storing for longer periods, the batteries can corrode and self-discharge.

OPERATION

- **Do not leave the switched-on measuring tool unattended and switch the measuring tool off after use.** Other persons could be blinded by the laser beam.
- **Protect the measuring tool against moisture and direct sun light.**
- **Do not subject the measuring tool to extreme temperatures or variations in temperature.** As an example, do not leave it in vehicles for longer periods. In case of large variations in temperature, allow the measuring tool to adjust to the ambient temperature before putting it into operation.

- **Avoid heavy impact to or falling down of the measuring tool.** After severe exterior effects to the measuring tool, it is recommended to carry out an accuracy check each time before continuing to work.

SWITCHING ON AND OFF (Fig. 2)

To **switch on** the measuring tool, push the on/off switch (3) up.

To **switch off**, slide the on/off switch down.

LASER LINE PROJECTION MODE

This self-levelling laser level has three laser-projection modes, horizontal 360° line, cross line and vertical line.

To select a specific laser-projection mode, press laser line projection mode select button (8) until you reach the desired projection mode.

It defaults to the cross line mode when it is turned on.

1. Press the button once to select the horizontal line.
2. Press the button twice to select the vertical line.
3. Press the button three times to return to the cross line.

WORKING MODE

This self-levelling laser level has two working modes, self-levelling mode and manual (lock) mode.

SELF-LEVELING MODE

In this mode, the tool will level itself if it is within $\pm 4^\circ$ of horizontal.

1. Place the self-levelling laser level on a flat, smooth horizontal surface within $\pm 4^\circ$ of horizontal.
2. Turn the tool on by sliding the on/off switch (4) to the upper position, it will automatically level within 4 seconds and the automatic leveling indicator will turn to green.
3. Press the mode button until the desired laser-projection mode is achieved and the laser line is projected from the laser aperture.
4. If the self-levelling laser out of leveling range, the LED will turn to red and the laser line will blink.
5. To turn off the laser lines, slide the switch back to off position.

MANUAL (LOCK) MODE

This mode cannot be used to perform horizontal or vertical leveling, because the laser lines are no longer self-leveling. In this mode, the LED indicator will always be in red.

1. Keep the power off, press the mode button to turn on the laser. The laser lines are now locked, and are no longer self-leveling.
2. Press the laser line projection mode select button repeatedly to change the laser projection mode.
3. Slope the self-leveling laser level to project a straight line for reference. In this mode, the laser lines are projected continuously and the indicator will not blink, even if the slope angle exceeds 4° .
4. To turn off the laser lines, slide the switch back to off position.

WARNING! When turning the laser on, always be aware of protecting your eyes and the eyes of those around you. Never point the laser light at anyone's face, including your own.

WORKING WITH TRIPOD (Fig. 3)

The use of a tripod (available separately) is particularly helpful for greater distances. The laser distance measure can be screwed onto a commercially available tripod using the 1/4" thread on the bottom side of the housing.

Place the measuring tool via the tripod mount (7) on to the 1/4" male thread of the tripod and screw the locking screw of the tripod tight.

HOLDING Laterally AGAINST A WALL OR OBJECT (Fig. 4)

For quick checking of heights, the measuring tool can be held by the contact surfaces (6) laterally against a vertical wall, cabinets, etc. Take care to hold the measuring tool straightly and calmly.

WORKING ADVICE

INFLUENCE EFFECTS ON THE WORKING RANGE

The working range depends upon the light conditions and the reflection properties of the target surface. For improved visibility of the laser beam when working outdoors and when the sunlight is intense, use the laser viewing glasses (accessory) and the laser target plate (accessory), or shade off the target surface.

MAINTENANCE

This laser distance measure has been designed to be a low-maintenance tool. However, in order to maintain its performance, you must always follow these simple directions.

1. **Always** handle the tool with care. Treat it as an optical device, such as a camera or binoculars.
2. **Avoid** exposing the tool to shock, continuous vibration or extreme hot or cold temperature.
3. **Always** store the tool indoors. When not in use, **ALWAYS** store the tool in its protective case.
4. **Always** Keep the tool free of dust and liquids. Use only a clean, soft cloth for cleaning. If necessary, slightly moisten the cloths with pure alcohol or a little water.
5. **Do not** touch the lens with your fingers.
6. Check the batteries regularly to avoid deterioration. **ALWAYS** remove the batteries from the tool, if it is not going to be used for an extended period of time.
7. Replace the batteries when the battery icon is continuously empty displayed on the LCD.
8. **Do not** disassemble the laser measuring tool; this will expose the user to hazardous radiation exposure.
9. **Do not** attempt to change any part of the laser lens.

SAVE THESE INSTRUCTIONS FOR FUTURE REFERENCE.

– NOTE –

– NOTE –

RYOBI POWER EQUIPMENT WARRANTY

Subject to the warranty conditions below, this RYOBI tool (hereinafter called "the Product"), is warranted by Ryobi (herein called "the Company") to be free from defects in material or workmanship for a period of 24 months from the date of original purchase covering both parts and labour. Under the terms of this warranty, the repair or replacement of any part shall be the opinion of the Company or its authorised agent. Should service become necessary during the warranty period, the owner should contact the authorised Ryobi retailer from whom the product was purchased, or the nearest Company branch office. In order to obtain warranty service, the owner must include the Sales Docket and Warranty Certificate to confirm date of purchase. This Product is sold by the dealer or agent as principal and the dealer has no authority from the Company to give any additional warranty or guarantee on the Company's behalf except as herein contained or herein referred to.

Warranty Conditions

This warranty only applies provided that the Product has been used in accordance with the manufacturer's recommendations under normal use and reasonable care (in the opinion of the Company) and such warranty does not cover consumable components, damage, malfunction or failure resulting from

misuse, neglect, abuse, or used for a purpose for which it was not designed, or is not suited and no repairs, alterations or modifications have been attempted by other than an Authorised Service Agent. This guarantee will not apply if the tool is damaged by accident or if repairs arise from normal wear and tear.

Accessories such as bits, blades, sanding discs, cutting lines, etc., are excluded from this guarantee. Normal consumable parts, such as carbon brushes, bearings, chucks, cord assembly's, spark plugs, recoil pulleys and bump head assembly's are specifically excluded from this guarantee.

The Company accepts no additional liability pursuant to this warranty for the costs of traveling or transportation of the Product or parts to and from the service dealer or agent - which costs are not included in the warranty.

Nothing herein shall have the effect of excluding, restricting or modifying any conditions, warranty, right or liability imposed, to the extent only that such exclusion, restriction or modification would render any term herein void.



STEVENS & CO (Pty) Ltd
604, 16th Street, Randjespark
Midrand, South Africa

P O Box 4059
HALFWAY HOUSE
1685, South Africa

Tel: +27 (11) 357-9600
Fax: +27 (11) 805-5541
email: stevens@ryobi.co.za

THIS WARRANTY FORM SHOULD BE RETAINED BY THE CUSTOMER AT ALL TIMES.

For your record and to assist in establishing date of purchase (necessary for in-warranty service), please keep your purchase docket and this form, completed with the following particulars.

PURCHASED FROM:.....

ADDRESS OF DEALER:.....

DATE:..... MODEL NO..... SERIAL NO.....

Present this form with your Purchase Docket when Warranty Service is required.