

RYOBI®

BHS-720

GB OWNER'S OPERATING MANUAL

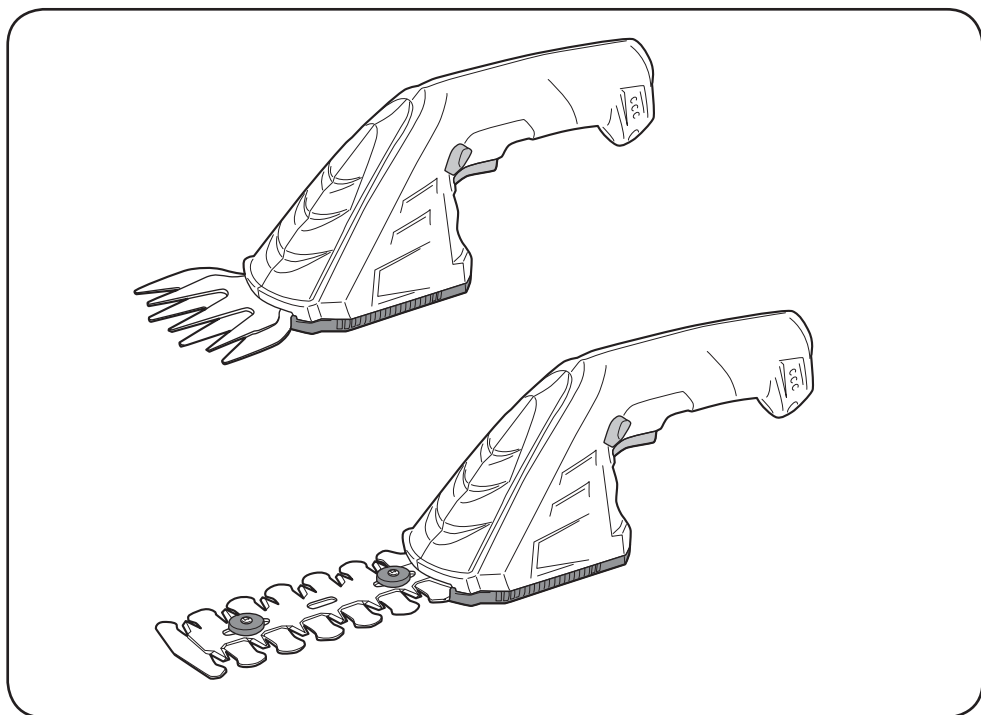

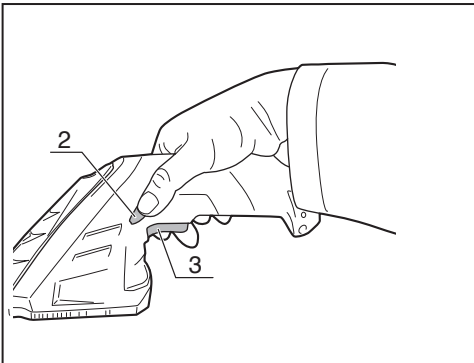
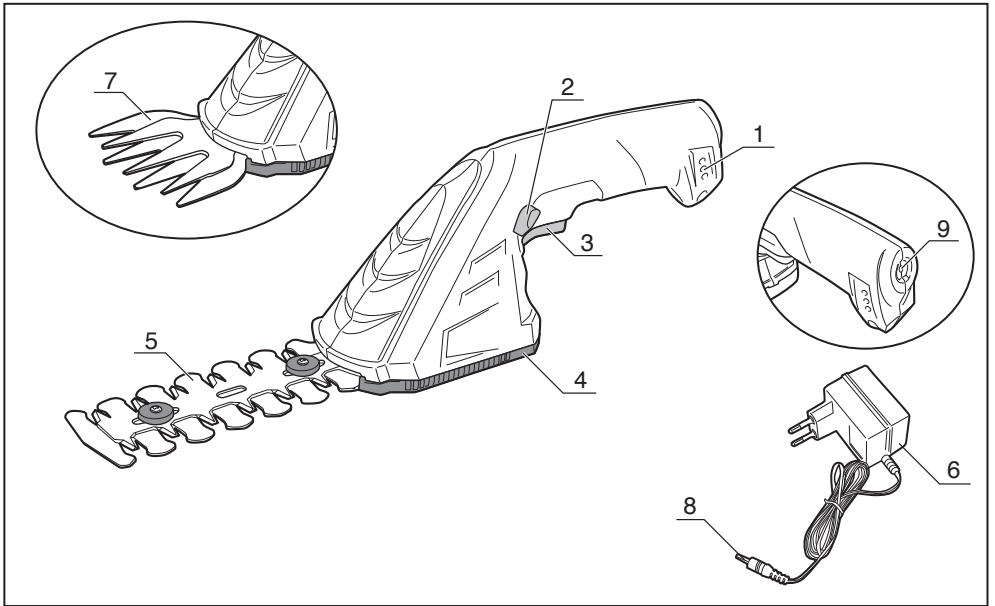

1

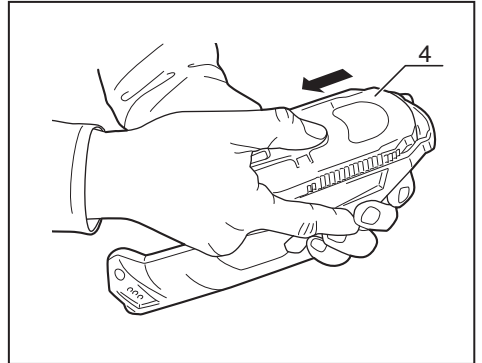

2

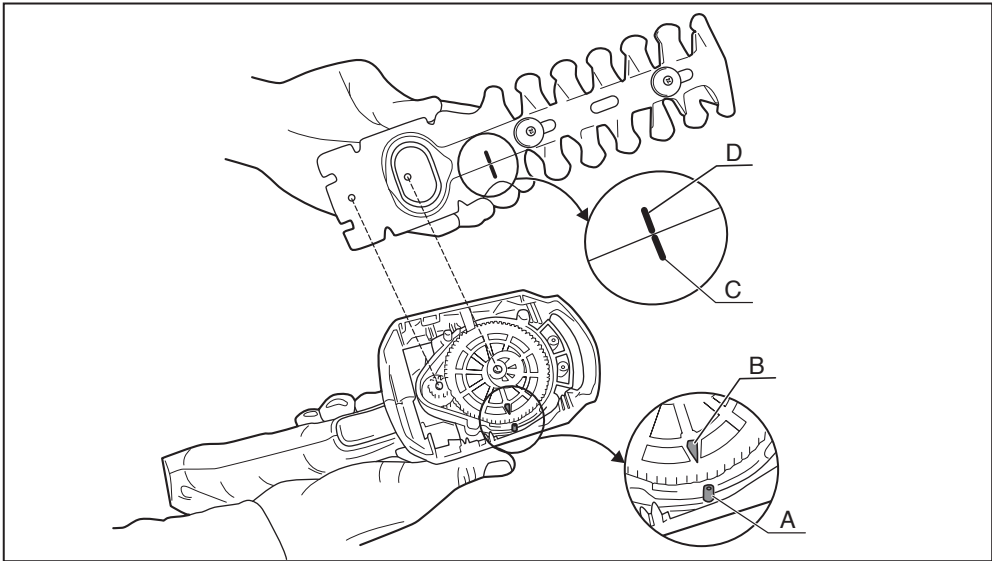

3

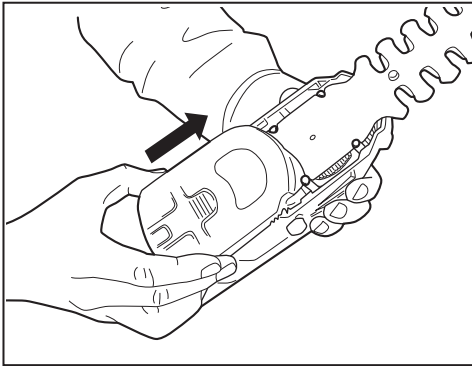

4

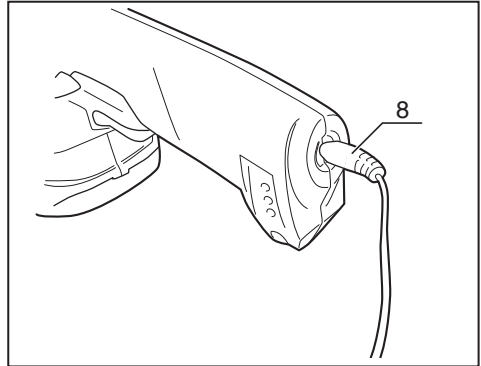

5

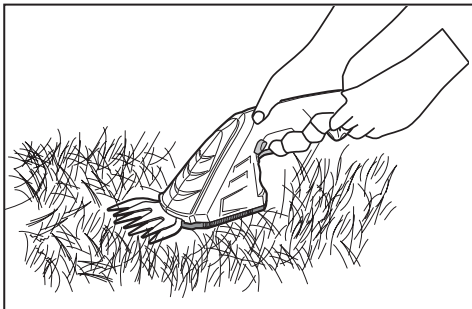

6

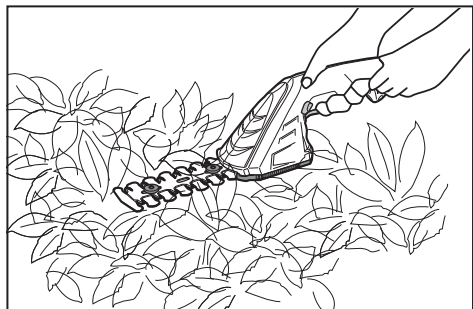

7



THANK YOU FOR BUYING A RYOBI PRODUCT.

To ensure your safety and satisfaction, carefully read through this OWNER'S MANUAL before using the product.

General Safety Rules

WARNING! Read all instructions. Failure to follow all instructions listed below may result in electric shock, fire and/or serious injury. The term "power tool" in all of the warnings listed below refers to your mains-operated (corded) power tool or battery-operated (cordless) power tool.

SAVE THESE INSTRUCTIONS

1) Work area

- a) **Keep work area clean and well lit.** Cluttered and dark areas invite accidents.
- b) **Do not operate power tools in explosive atmospheres, such as in the presence of flammable liquids, gases or dust.** Power tools create sparks which may ignite the dust or fumes.
- c) **Keep children and bystanders away while operating a power tool.** Distractions can cause you to lose control.

2) Electrical safety

- a) **Power tool plugs must match the outlet. Never modify the plug in any way. Do not use any adapter plugs with earthed (grounded) power tools.** Unmodified plugs and matching outlets will reduce risk of electric shock
- b) **Avoid body contact with earthed or grounded surfaces such as pipes, radiators, ranges and refrigerators.** There is an increased risk of electric shock if your body is earthed or grounded.
- c) **Do not expose power tools to rain or wet conditions.** Water entering a power tool will increase the risk of electric shock.
- d) **Do not abuse the cord. Never use the cord for carrying, pulling or unplugging the power tool. Keep cord away from heat, oil, sharp edges or moving parts.** Damaged or entangled cords increase the risk of electric shock.
- e) **When operating a power tool outdoors, use an extension cord suitable for outdoor use.** Use of a cord suitable for outdoor use reduces the risk of electric shock.

3) Personal safety

- a) **Stay alert, watch what you are doing and use common sense when operating a power tool. Do not use a power tool while you are tired or under the influence of drugs, alcohol or medication.** A moment of inattention while operating power tools may result in serious personal injury.
- b) **Use safety equipment. Always wear eye protection.** Safety equipment such as dust mask, non-skid safety shoes, hard hat, or hearing protection used for appropriate conditions will reduce personal injuries.
- c) **Avoid accidental starting. Ensure the switch is in the off-position before plugging in.** Carrying power tools with your finger on the switch or plugging in power tools that have the switch on invites accidents.
- d) **Remove any adjusting key or wrench before turning the power tool on.** A wrench or a key left attached to a rotating part of the power tool may result in personal injury.
- e) **Do not overreach. Keep proper footing and balance at all times.** This enables better control of the power tool in unexpected situations.
- f) **Dress properly. Do not wear loose clothing or jewellery. Keep your hair, clothing and gloves away from moving parts.** Loose clothes, jewellery or long hair can be caught in moving parts.

- g) **If devices are provided for the connection of dust extraction and collection facilities, ensure these are connected and properly used.** Use of these devices can reduce dust-related hazards.

4) Power tool use and care

- a) **Do not force the power tool. Use the correct power tool for your application.** The correct power tool will do the job better and safer at the rate for which it was designed.
- b) **Do not use the power tool if the switch does not turn it on and off.** Any power tool that cannot be controlled with the switch is dangerous and must be repaired.
- c) **Disconnect the plug from the power source and/or the battery pack from the power tool before making any adjustments, changing accessories, or storing power tools.** Such preventive safety measures reduce the risk of starting the power tool accidentally.
- d) **Store idle power tools out of the reach of children and do not allow persons unfamiliar with the power tool or these instructions to operate the power tool.** Power tools are dangerous in the hands of untrained users.
- e) **Maintain power tools. Check for misalignment or binding of moving parts, breakage of parts and any other condition that may affect the power tools operation. If damaged, have the power tool repaired before use.** Many accidents are caused by poorly maintained power tools.
- f) **Keep cutting tools sharp and clean.** Properly maintained cutting tools with sharp cutting edges are less likely to bind and are easier to control.
- g) **Use the power tool, accessories and tool bits etc., in accordance with these instructions and in the manner intended for the particular type of power tool, taking into account the working conditions and the work to be performed.** Use of the power tool for operations different from those intended could result in a hazardous situation.

5) Battery tool use and care

- a) **Ensure the switch is in the off position before inserting battery pack.** Inserting the battery pack into power tools that have the switch on invites accidents.
- b) **Recharge only with the charger specified by the manufacturer.** A charger that is suitable for one type of battery pack may create a risk of fire when used with another battery pack.
- c) **Use power tools only with specifically designated battery packs.** Use of any other battery packs may create a risk of injury and fire.
- d) **When battery pack is not in use, keep it away from other metal objects like paper clips, keys, nails, screws, or other metal objects that can make a connection from one terminal to another.** Shorting the battery terminals together may cause burns or a fire.
- e) **Under abusive conditions, liquid may be ejected from the battery; avoid contact. If contact accidentally occurs, flush with water. If liquid contacts eyes, additionally seek medical help.** Liquid ejected from the battery may cause irritation or burns.

6) Service

- a) **Have your power tool serviced by a qualified repair person using only identical replacement parts.** This will ensure that the safety of the power tool is maintained.

ADDITIONAL SAFETY RULES FOR YOUR CORD-LESS HEADGE TRIMMER AND GRASS SHEAR

1. After long working periods external metal parts and accessories could be hot.
2. Your grass shear will be warm when working, this is normal.
3. Prepare for use. Make sure that this grass shear has been correctly assembled and prepared for use as described in this user guide.
4. Uses the grass shear only in daylight or good artificial light.
5. Never hold the cutting blade near or point it at other people or animals when in use.
6. Always remove any thick sticks etc. from the hedge before use. Keep all parts of the body away from the cutter blade. Do not remove cut material nor hold material to be cut when blades are moving.
Make sure the switch is off when clearing jammed material. A moment of inattention while operating the machine may result in serious personal injury.
7. The cutting blade continues to move for a few moments after switching off. When transporting or storing the grass shear always fit the cutting device cover. Proper handling of the grass shear will reduce possible injury from the cutter blades.
8. Be sure of your footing. Always be sure of your footing when using steps and when working on slopes.
9. Do not cut branches that are too thick.
10. Never use the grass shear in rain or damp weather.
11. Check the cutting blade regularly, replace it if damaged. Use only the manufacturer's recommended replacement parts and accessories. The appliance should be inspected and maintained regularly.
Repairs should be carried out only by an authorized repairer.
12. Store the tool inside and keep out of the reach of children.
13. Never allow children to use the tool.
14. Heavy duty gloves should always be worn when using the hedge trimmer.
15. This trimmer has been designed to cut soft, new growth and should not be used on branches, hard wood or other form of cutting.
16. Do not attempt to free a jammed blade before first switching off the machine and removing the battery.
17. Do not use the hedge trimmer while you are tired or under the influence of drugs, alcohol or medication.
18. Check the hedge for foreign objects, e.g. wire fences.
19. Carry the grass shear by the handle with the cutting blade stopped.

ADDITIONAL SAFETY RULES FOR THE CHARGER

1. Do not allow any liquid to come into contact with the charger. There is a danger of electric shock.
2. The charger is not intended for any use other than charging the exact type of battery tool as supplied with the charger. Any other use may result in the risk of fire, electric shock or electrocution.
3. The charger and battery tool supplied with it are specifically designed to work together. Do not attempt to charge the battery tool with any other charger than the one supplied.
4. Do not place any object on top of the charger as it could cause overheating. Do not place the charger near any heat source.
5. Pull on the charger to disconnect it from the power source. Do not pull on the lead.
6. Make sure that the charger lead is positioned where it will not be stepped on, tripped over or otherwise subjected to damage or stress.
7. Do not use an extension cord unless it is absolutely necessary. The use of an improper extension cord could cause the risk of fire, electric shock or electrocution.

8. Do not use the charger if it has been subjected to a heavy knock, dropped or otherwise damaged in any way. Take the charger to an authorized service centre for a check or repair.
9. Do not disassemble the charger. Take it to an authorized service centre when service or repair is required. Incorrect re-assembly may result in the risk of fire, electric shock or electrocution.
10. To reduce the risk of an electric shock, unplug the charger from the power supply before attempting to clean it.
11. The charger is designed for use from a standard household electrical supply. Do not attempt to connect the charger to a supply with a different voltage.
12. Do not abuse cord or charger. Never use the cord to carry the charger. Do not pull the charger cord rather than the plug when disconnecting from receptacle. Damage to the cord or charger could occur and create an electric shock hazard. Replace damaged cords immediately.
13. Do not let gasoline, oils, petroleum-based products, etc. come in contact with plastic parts. They contain chemicals that can damage, weaken or destroy plastic.
14. Do not charge other batteries. SH-7.2V300 is suitable only for charging BHS-720. Otherwise there is danger of fire and explosion.
15. Do not use other battery chargers for charging BHS-720.

ADDITIONAL SAFETY RULES FOR THE BATTERY

1. To ensure the longest battery life and best battery performance, always charge the battery when the temperature is between 0~40°C (32-104°F). Do not charge the battery when the temperature is below 0°C (32°F), or above 50°C (122°F). This is important. Failure to observe this safety rule could cause serious damage to the battery.
2. Do not incinerate the battery even if it is seriously damaged or can no longer hold a charge.
The battery can explode in a fire.
3. A small leakage of liquid from the battery may occur under extreme usage or temperature.
This does not necessarily indicate a failure of the battery. However, if the outer seal is broken and this leakage comes into contact with your skin:
--- Wash the affected area quickly with soap and water.
--- Neutralise the liquid with a mild acid such as lemon juice or vinegar.
If the leakage gets in your eyes:
--- Flush your eyes with clean water for a minimum of 10 minutes and seek immediate medical attention. Inform the medical staff that the liquid is a 25-35% solution of potassium hydroxide.
4. Do not store or use the tool and battery in locations where the temperature may reach or exceed 50°C (122°F) such as alongside sheds or metal structures in the summer.
5. Allow the battery to cool down after charging. Do not place it in a hot environment such as a metal shed or open trailer left in the sun.
6. Only charge the battery with the charger supplied.

SYMBOLS

The rating plate on your tool may show symbols. These represent important information about the product or instructions on its use.



Read instruction manual



Do not expose to moisture or rain



For indoor use only



DESCRIPTION

- | | |
|------------------------|------------------|
| 1. Charging indicator | 2. Safety switch |
| 3. on/off switch | 4. Bottom cover |
| 5. Hedge trimmer blade | 6. Charger |
| 7. Grass shear blade | 8. Charger jack |
| 9. Charging socket | |

SPECIFICATIONS

Input	230V ~ 50 Hz 9W
Output	12V d.c. 300mA
Charger type	SH-7.2V300
Charging time	3 ~ 5 hours (approx)
Battery type	Li-ion
Battery capacity	1300 mAh
No load speed	1000 min ⁻¹
Cutting width (Hedge trimmer)	120 mm
(Grass shear)	100 mm
Net weight (Hedge trimmer)	0.8 kg
(Grass shear)	0.7 kg

STARTING AND STOPPING (Fig.1)

To start your Hedge Trimmer and Grass Shear

Push the safety switch (2) on either side and depress the on/off switch (3).

To stop your Hedge Trimmer and Grass Shear

Move hedge trimmer away from cutting area before stopping. To stop, release on/off switch.

NOTE: the tool can not be switched on while the on/off switch is depressed only.

BEFORE USE

⚠ WARNING! Always ensure that the tool is switched off and totally stop before operation.

1. REPLACING THE CUTTING BLADE

CAUTION: Always wear work gloves when replacing a blade.

Install the blade (Fig.2 , 3 , 4)

Mounting blade

1. Press the clip on the bottom cover (4) and pull along the direction mark, and remove the bottom cover from the tool.
2. Align the mark on the housing (A) and gear (B).
3. Align the marks on the fixed blade (C) and movable blade (D).
4. Position the two holes on the blade to the two pins on gears, and push the blade until it is fit into the housing.
5. Place the bottom cover on the tool and push the clip on it until the clip firmly locks to the tool.

Replacing blade

Remove the bottom cover in the same way as mounting blade, and then change the blade to which you require. Place back the bottom cover, and make sure it is fixed firmly to the tool.

2. CHARGING THE BATTERY (Fig. 5)

CAUTION: For indoor use only. Charge only with supplied charger. Your tool is delivered to you partly charged and must be fully charged before use. For the first charge we recommend charging for 10~12hours.

To charge, plug the charger jack (8) into the charging socket (9) and place the tool onto a clean dry surface.

Connect the charger to a suitable power point. The upper lamp will light up "RED" while you charging the tool and all three (3) lamps will light up GREEN after it becomes fully charged. While you operating the tool, all three (3) lamps lighting up GREEN means battery is full. The lamps will go off one by one as battery is exhausted, and the upper lamp will light up RED when battery becomes almost empty.

The charging time is approximately 3~5hours.

Disconnect the charger from the power point when battery is full charged.

NOTE: Whilst charging, the charger and the tool may become warm to touch, this is normal and does not indicate problem. Disconnect the charger from the power point when it is not in use and store it in a dry secure place.

WARNING: It is important to disconnect the charger from the power point after the battery is fully charged. Do not leave your battery on charge continuously as this may damage the battery. Avoid operating, charging or storing your battery in temperatures below 0°C and above 40°C.

OPERATION

⚠ CAUTION : Always wear eye protection.

1. Shearing (Fig. 6)

Remove all stones or other objects from within the working area. Push the safety switch forward and depress the on/off switch. Put down the device horizontally with your hand, and the blade should touch the ground. Results are best when the lawn is dry. **NOTE:** make sure there is no hard obstacle in the working area, such like stone etc. or the blade will be damaged.

2. Trimming (Fig. 7)

The device may be used to trim small hedges and shrubs. Hold the device in a slight angle to the hedge you would like to trim.

Trim the lateral areas from the lower to the upper edges first, and then trim the upper edge.

NOTE: wear safety goggles and eye protection to avoid accident.

MAINTENANCE AND REPAIR

⚠ WARNING! Always ensure that the tool is switched off and totally stop before making any adjustments or maintenance procedures.

- Never use water to cleaning the unit.
- Always clean the grass shear immediately after use. Brush the blade using a stiff nylon brush to remove any debris. Wear safety glasses to protect your eyes whilst cleaning.
- Always store the unit in a dry place.
- Inspect the grass shear before each use.
- Have the unit professionally repaired if any damage occurs.
- The blade rail should be cleaned and treated with fine oil after each use.
- Use the blade guard for transportation and storage.
- Regularly check that all the fixing screws are tight. They may vibrate loose over time.
- Keep the tool's cooling vents unclogged and clean at all times.
- Regularly check to see if any dust or foreign matter has entered the grills near the motor and around the switches.
- If the body of the tool needs cleaning, wipe it with a soft damp cloth. A mild detergent can be used but nothing like alcohol, petrol or other cleaning agent.

RYOBI POWER EQUIPMENT WARRANTY

Subject to the warranty conditions below, this RYOBI tool (hereinafter called "the Product"), is warranted by Ryobi (herein called "the Company") to be free from defects in material or workmanship for a period of 24 months from the date of original purchase covering both parts and labour. Under the terms of this warranty, the repair or replacement of any part shall be the opinion of the Company or its authorised agent. Should service become necessary during the warranty period, the owner should contact the authorised Ryobi retailer from whom the product was purchased, or the nearest Company branch office. In order to obtain warranty service, the owner must include the Sales Docket and Warranty Certificate to confirm date of purchase. This Product is sold by the dealer or agent as principal and the dealer has no authority from the Company to give any additional warranty or guarantee on the Company's behalf except as herein contained or herein referred to.

Warranty Conditions

This warranty only applies provided that the Product has been used in accordance with the manufacturer's recommendations under normal use and reasonable care (in the opinion of the Company) and such warranty does not cover consumable components, damage, malfunction or failure resulting from

misuse, neglect, abuse, or used for a purpose for which it was not designed, or is not suited and no repairs, alterations or modifications have been attempted by other than an Authorised Service Agent. This guarantee will not apply if the tool is damaged by accident or if repairs arise from normal wear and tear.

Accessories such as bits, blades, sanding discs, cutting lines, etc., are excluded from this guarantee. Normal consumable parts, such as carbon brushes, bearings, chucks, cord assembly's, spark plugs, recoil pulleys and bump head assembly's are specifically excluded from this guarantee.

The Company accepts no additional liability pursuant to this warranty for the costs of traveling or transportation of the Product or parts to and from the service dealer or agent - which costs are not included in the warranty.

Nothing herein shall have the effect of excluding, restricting or modifying any conditions, warranty, right or liability imposed, to the extent only that such exclusion, restriction or modification would render any term herein void.

RYOBI®

STEVENS & CO (Pty) Ltd

604, 16th Street, Randjespark
Midrand, South Africa

P O Box 4059
HALFWAY HOUSE
1685, South Africa

Tel: +27 (11) 357-9600
Fax: +27 (11) 805-5541
email: stevens@ryobi.co.za

THIS WARRANTY FORM SHOULD BE RETAINED BY THE CUSTOMER AT ALL TIMES.

For your record and to assist in establishing date of purchase (necessary for in-warranty service), please keep your purchase docket and this form, completed with the following particulars.

PURCHASED FROM:.....

ADDRESS OF DEALER:.....

DATE:..... MODEL NO..... SERIAL NO.....

Present this form with your Purchase Docket when Warranty Service is required.