

RYOBI

OWNER'S OPERATING MANUAL 180mm TILE CUTTER MODEL ETC-450

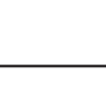

Thank you for buying a RYOBI tile cutter. Pay close attention to the Rules for Safe Operation, Warnings, and Cautions. If you use your tile cutter properly and only for what it is intended, you will enjoy years of safe, reliable service.

SAVE THIS MANUAL FOR FUTURE REFERENCE

RYOBI

OWNER'S OPERATING MANUAL 180mm TILE CUTTER MODEL ETC-450

SPECIFICATIONS

Input power.....	450 Watt
No load speed.....	3000 r/min
Depth of cut @ 90°.....	34 mm
Depth of cut @ 45°.....	22 mm
Max. Cutting depth.....	34 mm
Table size.....	395x385 mm
Blade size.....	Ø180xØ22.2 mm
Nett weight.....	11 kg
Gross weight.....	12 kg

THANK YOU FOR BUYING A RYOBI TILE CUTTER

Your new tile cutter has been engineered and manufactured to Ryobi's high standard of dependability, ease of operation, and operator safety. Properly cared for, it will give you years of rugged, trouble free performance. If you use your tile cutter properly and only for what it is intended, you will enjoy years of safe, reliable service.

CAUTION: Carefully read through this entire owner's manual, paying close attention to the general safety rules and rules for safe operation, before using.

KEEP THIS MANUAL FOR FUTURE REFERENCE

RULES FOR SAFE OPERATION

The purpose of safety rules is to attract your attention to possible dangers. The safety symbols and the explanations with them require your careful attention and understanding. The safety warnings do not by themselves eliminate any danger. The instructions or warnings they give are not substitutes for proper accident prevention measures.

SAFETY ALERT SYMBOL. Indicates caution or warning. May be used in conjunction with other symbols or pictures.

WARNING: Failure to obey a safety warning can result in serious injury to yourself or to others. Always follow the safety precautions to reduce the risk of fire, electric shock and personal injury.

WARNING: Do not attempt to operate this tool until you have read thoroughly and understood completely safety rules, etc. contained in this manual. Failure to comply can result in accidents involving fire, electric shock or serious personal injury. Save owners manual and review frequently for continuing safe operation and instructing others who may use this tool.

WEAR YOUR SAFETY GOGGLES The operation of any tool can result in foreign objects being thrown into your eyes, which can result in severe eye damage. Before beginning power tool operation, always wear safety goggles or safety glasses with side shields and a full face shield when needed. We recommend Wide Vision Safety Masks for use over eye glasses or standard safety glasses with side shields.

1. KNOW YOUR POWER TOOL. Read owners manual carefully. Learn its applications and limitations as well as the specific potential hazards related to this tool.
2. GUARD AGAINST ELECTRICAL SHOCK BY PREVENTING BODY CONTACT WITH GROUNDED SURFACES. For example, pipes, radiators, ranges, refrigerators, doors etc.

3. KEEP WORK AREA CLEAN. Cluttered areas and benches invite accidents.
4. AVOID DANGEROUS ENVIRONMENT. Don't use power tools in damp or wet locations or expose to rain. Keep work area well lit.
5. KEEP CHILDREN AND VISITORS AWAY. Visitors should wear safety glasses and be kept a safe distance from work area. Do not let visitors contact tool or extension cord.
6. STORE IDLE TOOLS. When not in use, tools should be stored in a dry and high or locked-up place, out of reach of children.
7. DON'T FORCE TOOL. It will do the job better and safer at the rate at which it was designed. Don't use tool for purpose not intended.
8. USE RIGHT TOOL. Don't force small tool or attachment to do the job of a heavy duty tool.
9. DRESS PROPERLY. Do not wear loose clothing or jewellery. They can be caught in moving parts. Rubber gloves and non-skid footwear are recommended when working outdoors. Also wear protective hair covering to contain long hair.
10. ALWAYS WEAR SAFETY GLASSES. Everyday eyeglasses have only impact resistant lenses, they are not safety glasses.
11. PROTECT YOUR LUNGS. Wear a dust mask if operation is dusty.
12. PROTECT YOUR HEARING. Wear hearing protection during extended periods of operation.
13. DON'T OVERREACH. Keep proper footing and balance at all times. Do not use tool on a ladder or unstable support. Secure tools when working at elevated levels.
14. MAINTAIN TOOLS WITH CARE. Keep tools sharp and clean for better and safer performance. Follow instructions for lubricating and changing accessories.
15. DISCONNECT TOOLS. When not in use, before servicing, or when changing attachments, blades, bits, cutters, etc. all tools should be disconnected.
16. REMOVE ADJUSTING KEYS AND WRENCHES. Before turning it on. From a habit of checking to see that keys and adjusting wrenches are removed from tool.
17. NEVER USE IN AN EXPLOSIVE ATMOSPHERE. Normal sparking of the motor could ignite fumes.

RULES FOR SAFE OPERATION

18. KEEP HANDLES DRY, CLEAN AND FREE FROM OIL AND GREASE. Always use a clean cloth when cleaning. Never use brake fluids, gasoline, petroleum based products, or any strong solvents to clean your tool.
19. STAY ALERT AND EXERCISE CONTROL. Watch what you are doing and use common sense. Do not operate tool when you are tired. Do not rush.
20. CHECK DAMAGED PARTS. Before further use of the tool, a guard or any other part that is damaged should be carefully checked to determine that it will operate properly and perform its intended function. Check for alignment of moving parts, binding of moving parts, breakage of parts, mounting and any other conditions that may affect its operation. A guard or any other part that is damaged should be properly repaired or replaced by an authorised service centre.
21. DO NOT USE TOOL, IF SWITCH DOES NOT TURN IT ON AND OFF. Have defective switches replaced by authorised service centre.
22. DO NOT OPERATE THIS TOOL WHILE UNDER THE INFLUENCE OF DRUGS, ALCOHOL OR ANY MEDICATION.
23. SUPPLY CORD. If the supply cord is damaged it must be replaced by the manufacturer or its service agent or similarly qualified person in order to avoid a hazard.

Due to continued product refinement policy, product features and specifications can and will change without notice. Check current features and specifications with your retailer.

SAVE THESE INSTRUCTIONS

DESCRIPTION

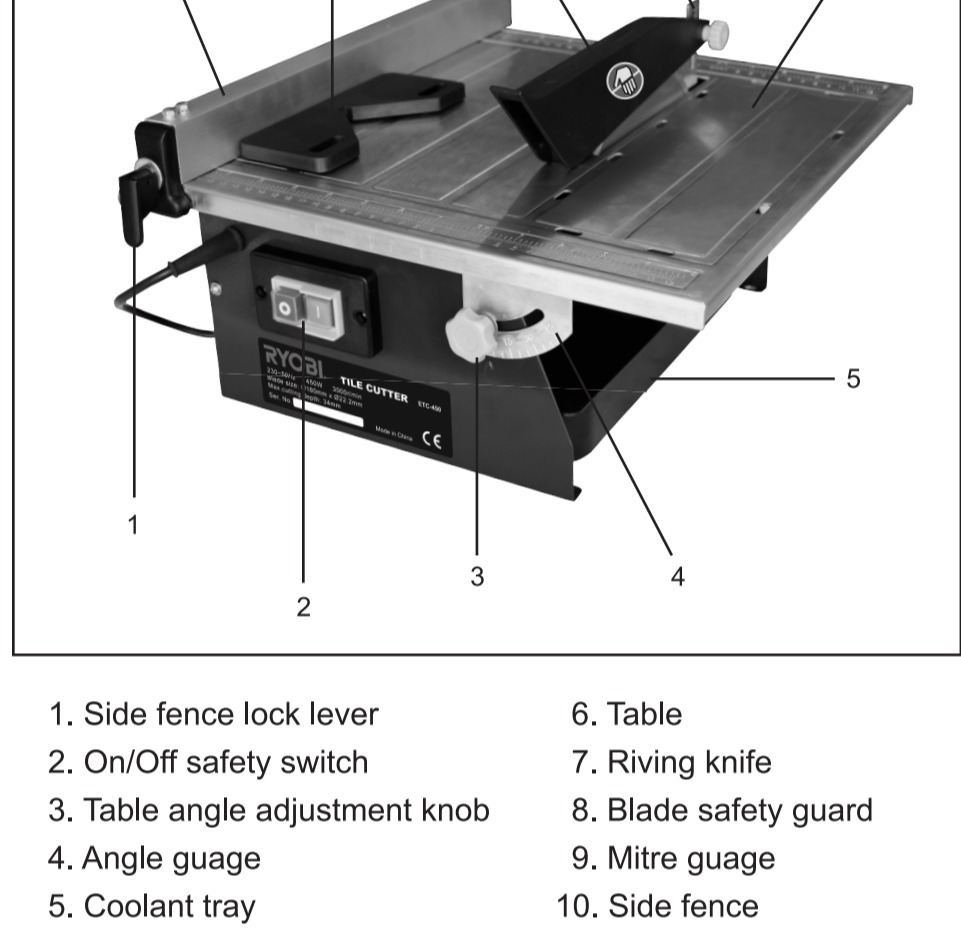

1. Side fence lock lever
2. On/Off safety switch
3. Table angle adjustment knob
4. Angle gauge
5. Coolant tray
6. Table
7. Riving knife
8. Blade safety guard
9. Mitre gauge
10. Side fence

ACCESSORIES

1. Blade guard
2. Side fence
3. Mitre gauge
4. Coolant tray
5. Spanner x 2

ASSEMBLY AND ADJUSTMENT

WARNING: If using an extension lead, ensure that the male and female plug connection is elevated and out of the way of any water contact.

WARNING: Do not attempt to turn the machine on without the blade safety guard properly assembled as serious personal injury may occur.

WARNING: Before attempting to assemble the blade safety guard, disconnect the power supply to prevent accidental starting which can cause serious personal injury.

To assemble the blade safety guard, align the 2 holes in the guard with the hole in the riving knife and secure with bolt and nut as illustrated. Do not over tighten. Leave proper space for materials going through. (Fig. 1)

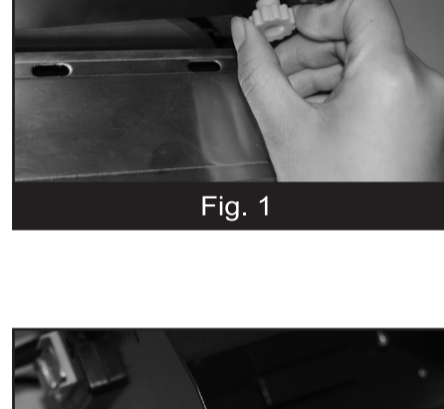

Insert the 4 rubber plugs to the base of the machine. (Fig. 2)

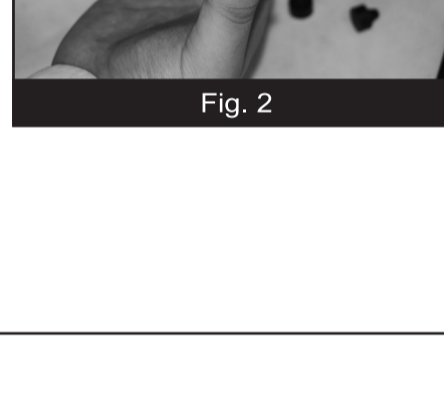

ASSEMBLY AND ADJUSTMENT

MOUNTING THE SIDE FENCE
Loosen the lock lever and slide the Side Fence into position you want. (Fig. 3)



Ensure that the Side Fence is level on the table and secure the lock lever. Rotate the lever to ensure that the back and front lock plates are in contact with the table. (Fig. 4)

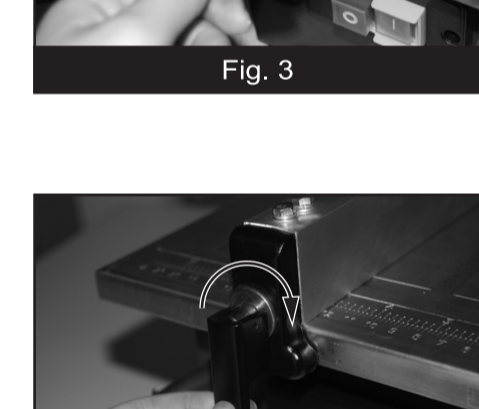

ON/OFF SAFETY SWITCH

NOTE: Before turning on the switch, make sure the blade safety guard is correctly installed and operating properly.

To start the machine, push the switch ON. When the blade is running stand on either side of the blade and never in front of it. Allow the blade to reach full speed before cutting. To stop the machine, push the switch OFF. (Fig. 5)



ASSEMBLY AND ADJUSTMENT

COOLANT TRAY
Before commencing cutting operation, fill the coolant tray with water to approx. Half capacity. The water will prevent the cutting wheel from overheating. (Fig. 6)



TABLE TILTING FOR BEVEL CUTTING
To tilt the table from 0° to 45° for bevel cutting, loosen both table angle adjustment knobs situated on the front and rear of the machine. (Fig. 7)

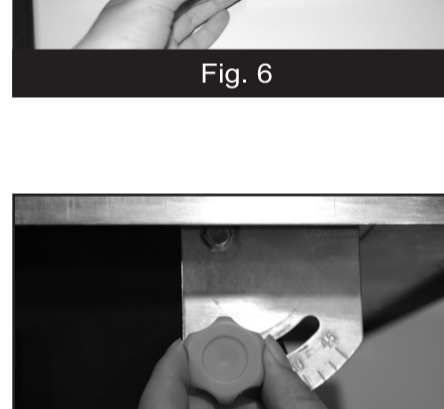

Tilt the table to the required angle and re-tighten both knobs.

BLADE INSTALLATION AND CHANGES

NOTE: This tile cutter is only designed for wet cutting, and only the continuous rim diamond blade can be used.

1. Unplug the machine from the power source!
2. Remove the water tank from underneath the machine.
3. Remove the lower blade guard by removing the screws on each side of the guard. (Fig. 8)

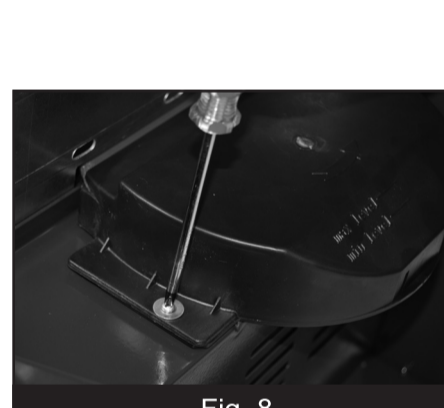

ASSEMBLY AND ADJUSTMENT

4. Use spanner A and spanner B to loosen and remove the arbor nut from the motor spindle. (Fig. 9)
5. Slide the outer flange and the diamond blade off the end of the motor spindle.
6. Slide the new diamond blade and the outer flange over the end of the motor spindle.

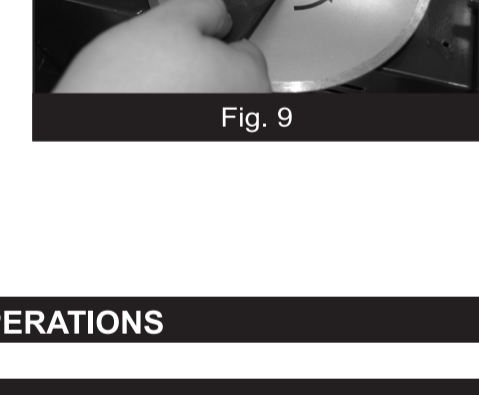

NOTE: Make sure the arrow printed on the diamond blade is in the same direction as the one on blade guard.

7. Thread and tighten the arbor nut onto the motor spindle to secure the diamond blade.
8. Re-install the lower blade guard.

BASIC OPERATIONS

WARNING! Never place your fingers or hands in the path of the blade as serious personal injury will occur.

WARNING! Always wear eye protection and gloves during operation to avoid serious personal injury.

CROSSCUTTING
Crosscutting is cutting the tile at 90°. Feed the tile gently into the blade ensuring that the side edge of the tile is flush against the side fence. (Fig. 10)

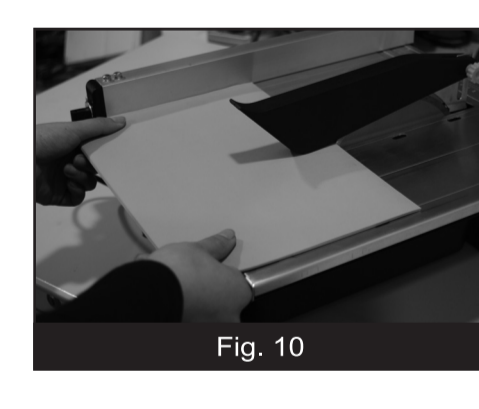

BASIC OPERATIONS

45° MITRE CROSSCUTTING
45° Mitre Crosscutting is cutting the tile at 45°. For precise 45° cutting, use the mitre gauge and side fence as illustrated. (Fig. 11)



BEVEL CROSSCUTTING
Bevel crosscutting is the same as crosscutting except that the tile is also cut at an angle other than 90°. Adjust the table to the desired angle. (Fig. 12)

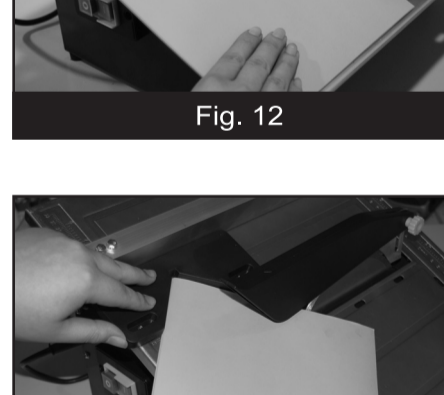

COMPOUND MITRE CUTTING
Compound mitre cutting is a combination of mitre cutting and bevel crosscutting at 45° to both the edge and flat side of the tile. Adjust the mitre gauge and the table to the desired angle. (Fig. 13)

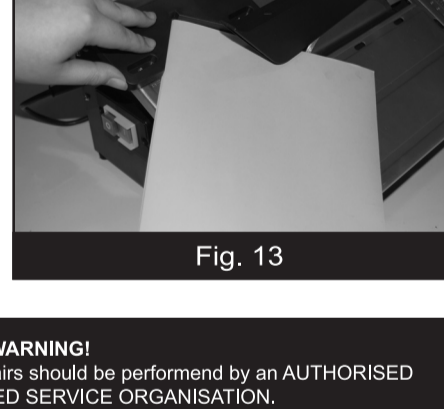

WARNING! To assure safety and reliability, all repairs should be performed by an AUTHORISED SERVICE CENTRE or other QUALIFIED SERVICE ORGANISATION.

RYOBI POWER EQUIPMENT WARRANTY

Subject to the warranty conditions below, this RYOBI tool (hereinafter called "the Product") is warranted by Ryobi (herein called "the Company") to be free from defects in material or workmanship for a period of 24 months from the date of original purchase covering both parts and labour. Under the terms of this warranty, the repair or replacement of any part shall be the option of the Company or its authorised agent. Should service become necessary during the warranty period, the owner should contact the authorised Ryobi retailer from whom the product was purchased, or the nearest Company branch office. In order to obtain warranty service, the owner must include the Sales Docket and Warranty Certificate to confirm date of purchase. This Product is sold by the dealer or agent as principal and the dealer has no authority from the Company to give any additional warranty or guarantee on the Company's behalf except as herein contained or herein referred to.

Warranty Conditions
This warranty only applies provided that the Product has been used in accordance with the manufacturer's recommendations under normal use and reasonable care (in the opinion of the Company) and such warranty does not cover consumable components, damage, malfunction or failure resulting from

misuse, neglect, abuse, or used for a purpose for which it was not designed, or is not suited and no repairs, alterations or modifications have been attempted by other than an Authorised Service Agent. This guarantee will not apply if the tool is damaged by accident or if repairs arise from normal wear and tear. Accessories such as bits, blades, sanding discs, cutting lines, etc., are excluded from this guarantee. Normal consumable parts, such as carbon brushes, bearings, chucks, cord assembly's, spark plugs, recoil pulleys and bump head assembly's are specifically excluded from this guarantee. The Company accepts no additional liability pursuant to this warranty for the costs of travelling or transportation of the Product or parts to and from the service dealer or agent - which costs are not included in the warranty. Nothing herein shall have the effect of excluding, restricting or modifying any conditions, warranty, right or liability imposed, to the extent only that such exclusion, restriction or modification would render any term herein void.



STEVENS & CO (Pty) Ltd P O Box 4059 Tel: +27 (11) 805-5540
644, 16th Street, Randespark HALFWAY HOUSE Fax: +27 (11) 805-5541
Midrand, South Africa 1685, South Africa Email: stovera@ryobi.co.za

THIS WARRANTY FORM

SHOULD BE RETAINED BY THE CUSTOMER AT ALL TIMES. For your record and to assist in establishing date of purchase (necessary for in-warranty service), please keep your purchase docket and this form, completed with the following particulars.

PURCHASED FROM.....
ADDRESS OF DEALER.....
DATE..... MODEL NO..... SERIAL NO.....

Present this form with your Purchase Docket when Warranty Service is required.