

RYOBI®

HP-1050

GB OWNER'S OPERATING MANUAL

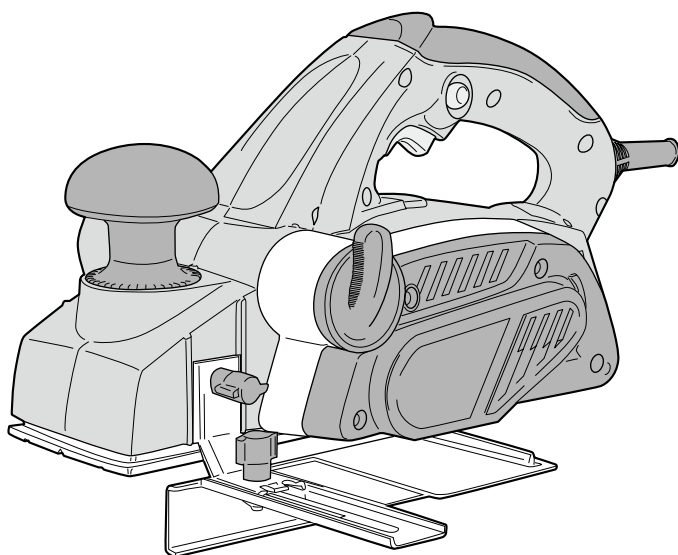

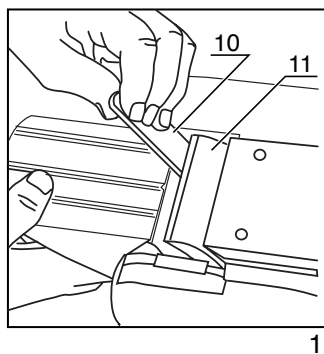
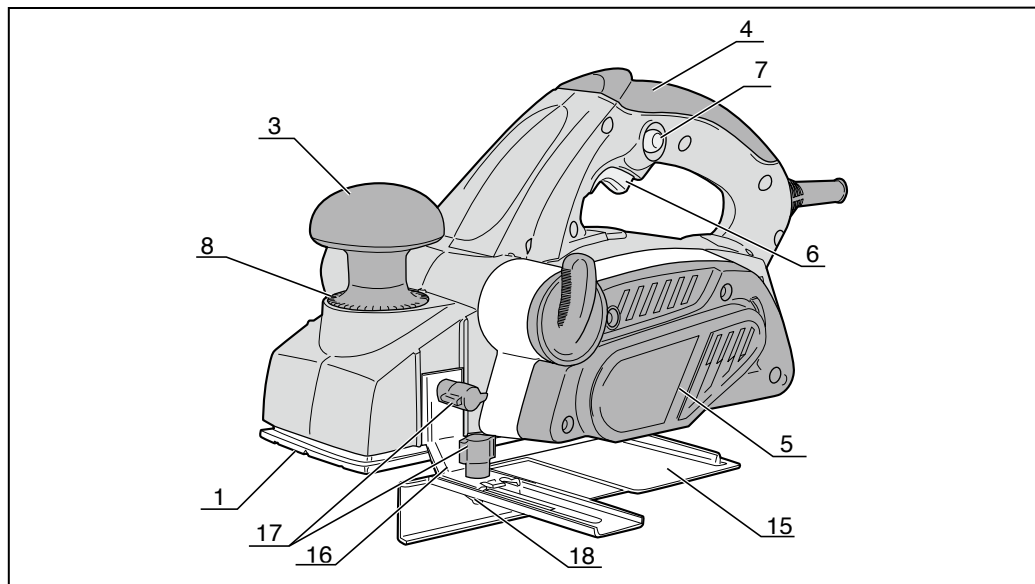

1

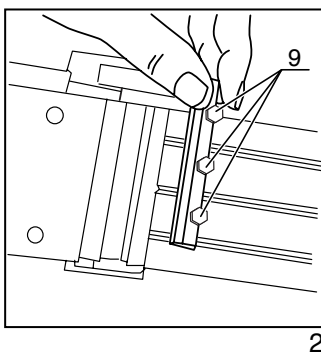

2

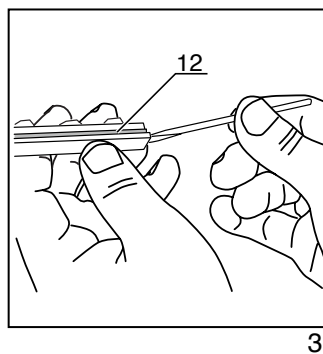

3

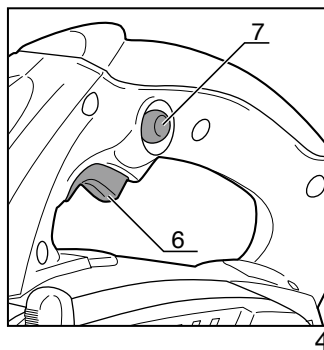

4

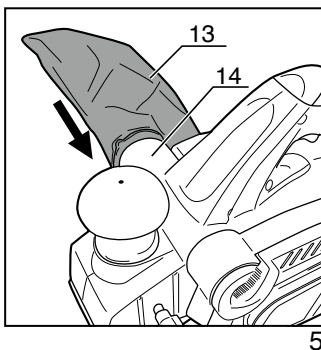

5

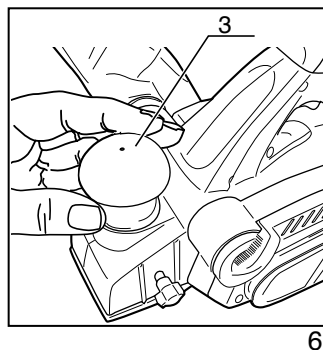

6

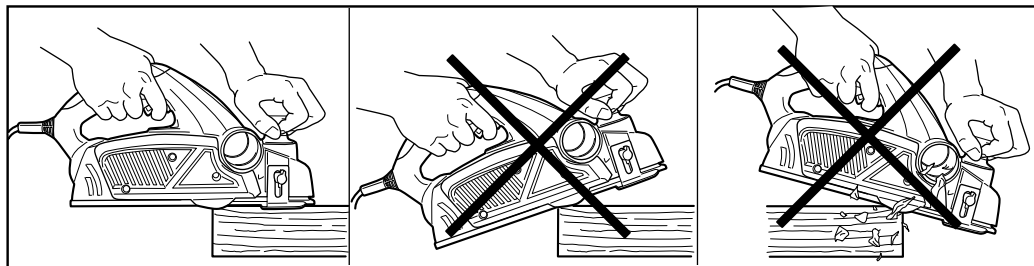

7

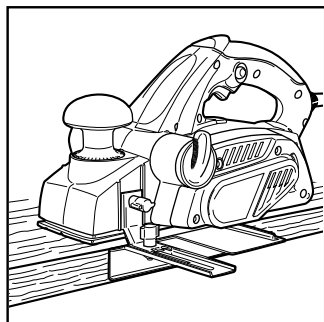

8

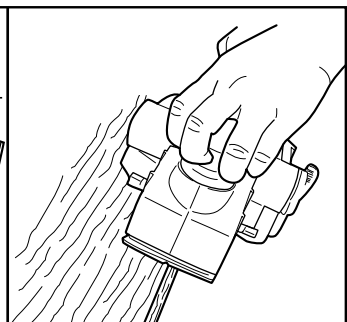
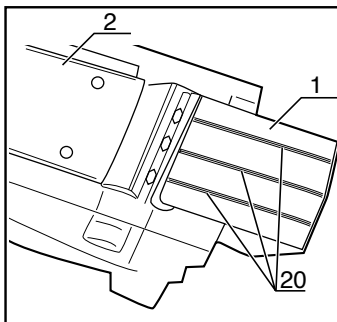

9

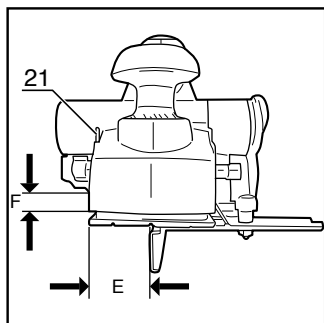

10

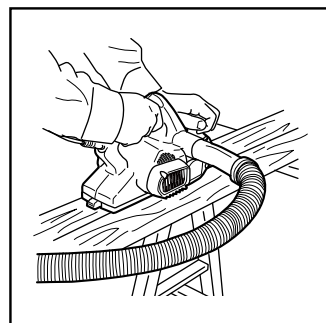

11



THANK YOU FOR BUYING A RYOBI PRODUCT.

To ensure your safety and satisfaction, carefully read through this OWNER'S MANUAL before using the product.

General Safety Rules

WARNING! Read all instructions. Failure to follow all instructions listed below may result in electric shock, fire and/or serious injury. The term "power tool" in all of the warnings listed below refers to your mains-operated (corded) power tool or battery-operated (cordless) power tool.

SAVE THESE INSTRUCTIONS

1) Work area

- Keep work area clean and well lit.** Cluttered and dark areas invite accidents.
- Do not operate power tools in explosive atmospheres, such as in the presence of flammable liquids, gases or dust.** Power tools create sparks which may ignite the dust or fumes.
- Keep children and bystanders away while operating a power tool.** Distractions can cause you to lose control.

2) Electrical safety

- Power tool plugs must match the outlet. Never modify the plug in any way. Do not use any adapter plugs with earthed (grounded) power tools.** Unmodified plugs and matching outlets will reduce risk of electric shock.
- Avoid body contact with earthed or grounded surfaces such as pipes, radiators, ranges and refrigerators.** There is an increased risk of electric shock if your body is earthed or grounded.
- Do not expose power tools to rain or wet conditions.** Water entering a power tool will increase the risk of electric shock.
- Do not abuse the cord. Never use the cord for carrying, pulling or unplugging the power tool. Keep cord away from heat, oil, sharp edges or moving parts.** Damaged or entangled cords increase the risk of electric shock.
- When operating a power tool outdoors, use an extension cord suitable for outdoor use.** Use of a cord suitable for outdoor use reduces the risk of electric shock.

3) Personal safety

- Stay alert, watch what you are doing and use common sense when operating a power tool. Do not use a power tool while you are tired or under the influence of drugs, alcohol or medication.** A moment of inattention while operating power tools may result in serious personal injury.
- Use safety equipment. Always wear eye protection.** Safety equipment such as dust mask, non-skid safety shoes, hard hat, or hearing protection used for appropriate conditions will reduce personal injuries.
- Avoid accidental starting. Ensure the switch is in the off-position before plugging in.** Carrying power tools with your finger on the switch or plugging in power tools that have the switch on invites accidents.
- Remove any adjusting key or wrench before turning the power tool on.** A wrench or a key left attached to a rotating part of the power tool may result in personal injury.
- Do not overreach. Keep proper footing and balance at all times.** This enables better control of the power tool in unexpected situations.
- Dress properly. Do not wear loose clothing or jewellery. Keep your hair, clothing and gloves away from moving parts.** Loose clothes, jewellery or long hair can be caught in moving parts.
- If devices are provided for the connection of dust extraction and collection facilities, ensure these are connected and properly used.** Use of these devices can reduce dust-related hazards.

4) Power tool use and care

- Do not force the power tool. Use the correct power tool for your application.** The correct power tool will do the job better and safer at the rate for which it was designed.
- Do not use the power tool if the switch does not turn it on and off.** Any power tool that cannot be controlled with the switch is dangerous and must be repaired.
- Disconnect the plug from the power source and/or the battery pack from the power tool before making any adjustments, changing accessories, or storing power tools.** Such preventive safety measures reduce the risk of starting the power tool accidentally.
- Store idle power tools out of the reach of children and do not allow persons unfamiliar with the power tool or these instructions to operate the power tool.** Power tools are dangerous in the hands of untrained users.
- Maintain power tools. Check for misalignment or binding of moving parts, breakage of parts and any other condition that may affect the power tools operation. If damaged, have the power tool repaired before use.** Many accidents are caused by poorly maintained power tools.
- Keep cutting tools sharp and clean.** Properly maintained cutting tools with sharp cutting edges are less likely to bind and are easier to control.
- Use the power tool, accessories and tool bits etc., in accordance with these instructions and in the manner intended for the particular type of power tool, taking into account the working conditions and the work to be performed.** Use of the power tool for operations different from those intended could result in a hazardous situation.

5) Service

- Have your power tool serviced by a qualified repair person using only identical replacement parts.** This will ensure that the safety of the power tool is maintained.

PLANER SAFETY RULES:

- Wait for the cutter to stop before setting the tool down. An exposed cutter may engage the surface leading to possible loss of control and serious injury.

INSTRUCTIONS FOR SAFE HANDLING

- Make sure that the tool is only connected to the voltage marked on the name plate.
- Never use the tool if its cover or any bolts are missing. If the cover or bolts have been removed, replace them prior to use. Maintain all parts in good working order.
- Always secure the tool when working in elevated positions.
- Never touch the blade, drill bit, grinding wheel or other moving parts during use.
- Never start the tool when its rotating component is in contact with the work piece.
- Never lay the tool down before its moving parts have come to a complete stop.
- ACCESSORIES:** The use of accessories or attachments other than those recommended in this manual might present a hazard.
- REPLACEMENT PARTS :** When servicing use only identical replacement parts.
- Before connecting this tool to the power source, ensure that the cutter blades are mounted according to the details in these instructions and that all bolts are tightened securely. Loose bolts may cause the blades to fly off, causing a serious accident.
- It is extremely dangerous to point the cutting surface toward any person.
- Be careful when attaching and removing the blades as they are extremely sharp and could cause serious injury if mishandled.

12. Never put your hands near the belt cover during operation as it is not covered on the bottom.
13. Make sure the workplace is free from nails and other foreign objects which could damage the blades or cause accidents.
14. Hold the tool securely when starting, because inertia from the motor can cause the planer to jump from your grasp.
15. Hold the tool with both hands during operation - holding it with only one hand is dangerous.
16. It is extremely dangerous to place fingers or objects in the chip outlet where they could come into contact with the rotating blades.
17. Make sure that the rabbeting cover, which protects your hands from the blades, moves smoothly and is completely covering the cutter blades prior to operation.
18. Replace cutter blades as a pair. Replacing them individually will cause incorrect balance, resulting in vibration during operation and reduced tool life.
19. Dull blades increase the danger of kickback.
20. Keep front shoe halves as close together as work permits.
21. The unused part of the cutter block must be covered at all times.
22. Use the chip eject cover for planing.
23. Use safety equipment. Always wear a dust mask.
24. Before use, check the Stand device whether work normally.
25. If it is damaged, please stop use and send to the service center.

DESCRIPTION (Fig. 1)

1. Front shoe
2. Rear shoe
3. Adjustment knob
4. Handle
5. Belt cover
6. Switch
7. Lock button
8. Depth-of-cut-scale
9. Blade securing nut
10. Wrench
11. Blade holder
12. Blade
13. Dust bag
14. Chip deflector outlet
15. Side plate
16. Side plate support
17. Fixing knob
18. Nut
20. Groove
21. Rabbeting depth adjustment gauge

SPECIFICATIONS

Planing depth	0-3.5 mm
Planing width	82 mm
Input	1,050 watt
No load speed	15,000 min ⁻¹
Overall length	330 mm
Net weight	3.9 kg

STANDARD ACCESSORIES

Wrench, Side plate, Fixing knob, Nut, Rabbeting depth adjustment gauge

APPLICATIONS

(Use only for the purposes listed below.)

1. Planing wood.

REPLACING THE BLADE (Fig. 1 – 3)

1. Loosen the three blade securing nuts (9) with wrench (10), and remove the blade holder (11).
2. Push the blade (12) out from the blade holder using a small screwdriver.
3. Place the new blade in the blade holder.
4. Insert the blade holder back in position and re-tighten the three nuts.

SWITCH (Fig. 4)

This tool is started and stopped by depressing and releasing the switch (6).

For continuous operation, press the lock button (7) while switch is depressed. Depress again to release the lock.

ATTACHING THE DUST BAG (Fig. 5)

The tool is designed to accept a dust bag (13) which can be fitted to the left or right chip deflector outlet (14) as illustrated. To fit the dust bag, simply insert the tube end of the bag into the chip deflector outlet.

ADJUSTING THE PLANING DEPTH (Fig. 6)

The planing depth can be adjusted approximately between 0mm and 3.5mm. To adjust the depth, turn the adjustment knob (3) to the desired setting on the depth-of-cut scale (8).

Always work from a rough cut to a finish cut. For rough planing use a setting from 0.5mm to 1mm. For finish planing use a setting from 0.2mm to 0.4mm.

CAUTION!

DO NOT TURN THE DEPTH ADJUSTMENT KNOB MORE THAN THE MAXIMUM PLANING DEPTH OF 1MM.

OPERATING INSTRUCTIONS (Fig. 7)

1. Be sure the work piece is clamped or otherwise firmly secured.
2. With one hand holding the depth adjustment knob and the other gripping the handle (4), place the front shoe (1) on the edge of the piece to be planed.
3. Before starting the planer, be sure the blades are not in contact with the work piece.
4. Position the planer so that the front shoe is perfectly flat and level on the piece to be worked.
5. Using a slow, steady motion, begin planing with the motor at full torque.

IMPORTANT!

Be especially careful to keep the planer flat and level at the beginning and end of each planing stroke, or else unsightly beveled edges will be formed.

SIDE PLATE (Fig. 8)

The side plate (15) helps to plane long and uneven surfaces accurately. To use the side plate, attach the side plate support (16) to the tool with fixing knob (17), and fix the side plate on the side plate support with fixing knob and nut (18).

EDGE PLANING (Fig. 9)

This planer has precision machined grooves (20) of 3 different depth on the front shoe for bevel planing. Before planing good timber, make a few cuts on a piece of scrap timber to determine the desired depth.



RABBETTING (Fig. 10)

Attach the rabbetting depth adjustment gauge (21) and side plate with fixing knob. Width of rebating cut (E) is adjustable by moving the side plate. The depth of rebating cut (F) can be adjusted by moving the rabbetting depth adjustment gauge, and also the number of passes made along the work piece. Before working the actual piece, determine the desired depth using a piece of scrap wood. While planing, the side plate should rest on edge of the work piece.

The maximum rabbet cut depth is 14mm.

ATTACHING THE VACUUM (Fig. 11)

The dust can be collected by using a vacuum cleaner.

Connect the vacuum cleaner hose to the chip deflector outlet.

MAINTENANCE

After use, check the tool to make sure that it is in top condition.

It is recommended that you take this tool to a Ryobi Authorized Service Center for a through cleaning and lubrication at least once per year.

DO NOT MAKE ANY ADJUSTMENTS WHILE THE MOTOR IS IN MOTION.

ALWAYS DISCONNECT THE POWER CORD FROM THE RECEPTACLE BEFORE CHANGING REMOVABLE OR EXPENDABLE PARTS (BLADE, BIT, SANDING PAPER ETC.), LUBRICATING OR WORKING ON THE UNIT

WARNING!

To ensure safety and reliability, all repairs should be performed by an AUTHORIZED SERVICE CENTER or other QUALIFIED SERVICE ORGANIZATION.

SAVE THESE INSTRUCTIONS FOR FUTURE REFERENCE.

“  **WARNING** To reduce the risk of injury, user must read instruction manual ”

RYOBI POWER EQUIPMENT WARRANTY

Subject to the warranty conditions below, this RYOBI tool (hereinafter called "the Product"), is warranted by Ryobi (herein called "the Company") to be free from defects in material or workmanship for a period of 24 months from the date of original purchase covering both parts and labour. Under the terms of this warranty, the repair or replacement of any part shall be the opinion of the Company or its authorised agent. Should service become necessary during the warranty period, the owner should contact the authorised Ryobi retailer from whom the product was purchased, or the nearest Company branch office. In order to obtain warranty service, the owner must include the Sales Docket and Warranty Certificate to confirm date of purchase. This Product is sold by the dealer or agent as principal and the dealer has no authority from the Company to give any additional warranty or guarantee on the Company's behalf except as herein contained or herein referred to.

Warranty Conditions

This warranty only applies provided that the Product has been used in accordance with the manufacturer's recommendations under normal use and reasonable care (in the opinion of the Company) and such warranty does not cover consumable components, damage, malfunction or failure resulting from

misuse, neglect, abuse, or used for a purpose for which it was not designed, or is not suited and no repairs, alterations or modifications have been attempted by other than an Authorised Service Agent. This guarantee will not apply if the tool is damaged by accident or if repairs arise from normal wear and tear.

Accessories such as bits, blades, sanding discs, cutting lines, etc., are excluded from this guarantee. Normal consumable parts, such as carbon brushes, bearings, chucks, cord assembly's, spark plugs, recoil pulleys and bump head assembly's are specifically excluded from this guarantee.

The Company accepts no additional liability pursuant to this warranty for the costs of traveling or transportation of the Product or parts to and from the service dealer or agent - which costs are not included in the warranty.

Nothing herein shall have the effect of excluding, restricting or modifying any conditions, warranty, right or liability imposed, to the extent only that such exclusion, restriction or modification would render any term herein void.

RYOBI®

STEVENS & CO (Pty) Ltd

604, 16th Street, Randjespark
Midrand, South Africa

P O Box 4059
HALFWAY HOUSE
1685, South Africa

Tel: +27 (11) 357-9600
Fax: +27 (11) 805-5541
email: stevens@ryobi.co.za

THIS WARRANTY FORM SHOULD BE RETAINED BY THE CUSTOMER AT ALL TIMES.

For your record and to assist in establishing date of purchase (necessary for in-warranty service), please keep your purchase docket and this form, completed with the following particulars.

PURCHASED FROM:.....

ADDRESS OF DEALER:.....

DATE:..... MODEL NO..... SERIAL NO.....

Present this form with your Purchase Docket when Warranty Service is required.